



## Novoescocia® 4 PVC



Novoescocia® 4 PVC is a cove-shaped profile made of white PVC extrusion. This solution avoids build-up of germs and dirt in the meeting points between wall-floor-ceiling, facilitating the cleaning. It is slightly flexible to adapt to the irregularities of any wall or floor. It is ideal for being installed in areas as industrial kitchens, refrigerators, dressing rooms... Available in two different sizes.

### General features

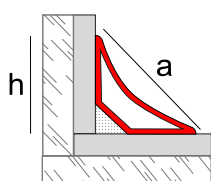

Material:	PVC	
Length:	2,5 m.l. (8.2")	
Measures:	h: 25 mm. (1")	h: 14 mm (9/16")
	a: 36,5 mm. (1 1/2")	a: 20 mm (13/16")
Packaging:	30 u/box	100 u/box

### Complementary pieces

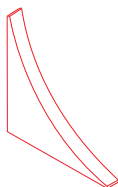

Novoescocia® 4 PVC has available and end cover for a perfect finish.

### Applications

Scope of Novoescocia® 4 PVC:

- Corners between walls and kitchen countertops
- Perimeters in shower trays or bathtubs.
- Encounters: wall-floor, wall-wall or wall-ceiling both horizontally and vertically.

It is ideal for bathrooms, kitchens, medical consultations, restaurants, etc...

Its design is versatile and is appropriate for homes, offices, public buildings or installations with high requirements of hygiene and cleaning.

### Technical features and Tests

Fire resistance	M1 (NBE-CPI-96)*
Abrasion resistance	Very good
Working temperature	-10°C / 60°C
Resistance to chemical agents	Good except with chromic acid, sulfuric and organic solvents as acetate and toluene

AIMPLAS

\*No flammable fuel

### Materials

#### PVC

Novoescocia® 4 PVC is a profile made by coextrusion of PVC-P (rigid PVC) and PVC-U (flexible PVC). PVC-U provides a perfect adaptability to corners while PVC-P is suitable, due to its rigidity, to be the piece to be placed in the tiles as a support.

PVC (polyvinyl chloride), is a polar amorphous thermoplastic polymer highly resistant to abrasion, corrosion and a wide range of chemical products. Has a good resistance to impact, low water absorption, low electrical conductivity and is dimensionally stable.

### Installation

Please, clean the surface where Novoescocia® 4 PVC is going to be installed:

1. Apply a big amount of adhesive on the rear surfaces of the rigid piece of Novoescocia® 4.
2. Place the rigid piece on the encounter between wall and bathtub (or the encounter you need) and press, so both faces to join will make perfect contact with the surface.
3. Then, let dry.

### Cleaning and maintenance

The cleaning can be done with water and detergent or specific cleaner diluted. The correct use of bleach do not affect PVC.

It is not recommended using chromic acid, sulfuric acid or organic solvents as ethyl acetate, acetone or toluene.

### Technical information

You can find out more information about the technical features of Emac®'s products by downloading its Technical File in [www.emac.es](http://www.emac.es).

If you have any query, please contact our Technical Department in [tecnico@emac.es](mailto:tecnico@emac.es).

